

THIS DRAWING IS UNPUBLISHED. RELEASED FOR PUBLICATION, 19 .  
 © COPYRIGHT 19 BY AMP INCORPORATED. ALL INTERNATIONAL RIGHTS RESERVED.

LOC	DIST	P	F	REVISIONS			
ZONE	LTR	DESCRIPTION	DATE	APPD			
AF	50			C	REV PER AF-6942	8/23/90	DKS

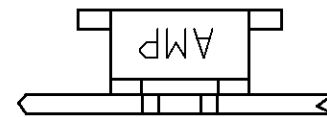

- 1 CONTINUOUS STRIP ON REELS WITH TERMINALS LOCATED ON 5.08 [.200] CENTERS
- △2 SLOT ACCEPTS 0.18-0.23mm DIA [#33-#31]AWG COPPER MAGNET WIRE
- △3 TIN LEAD 0.00380 [.000150] MIN PER MIL-T-10727 OVER NICKEL 0.00127 [.000050] MIN PER QQ-N-290.

IDENTIFICATION NUMBER FOR MAGNET WIRE RANGE

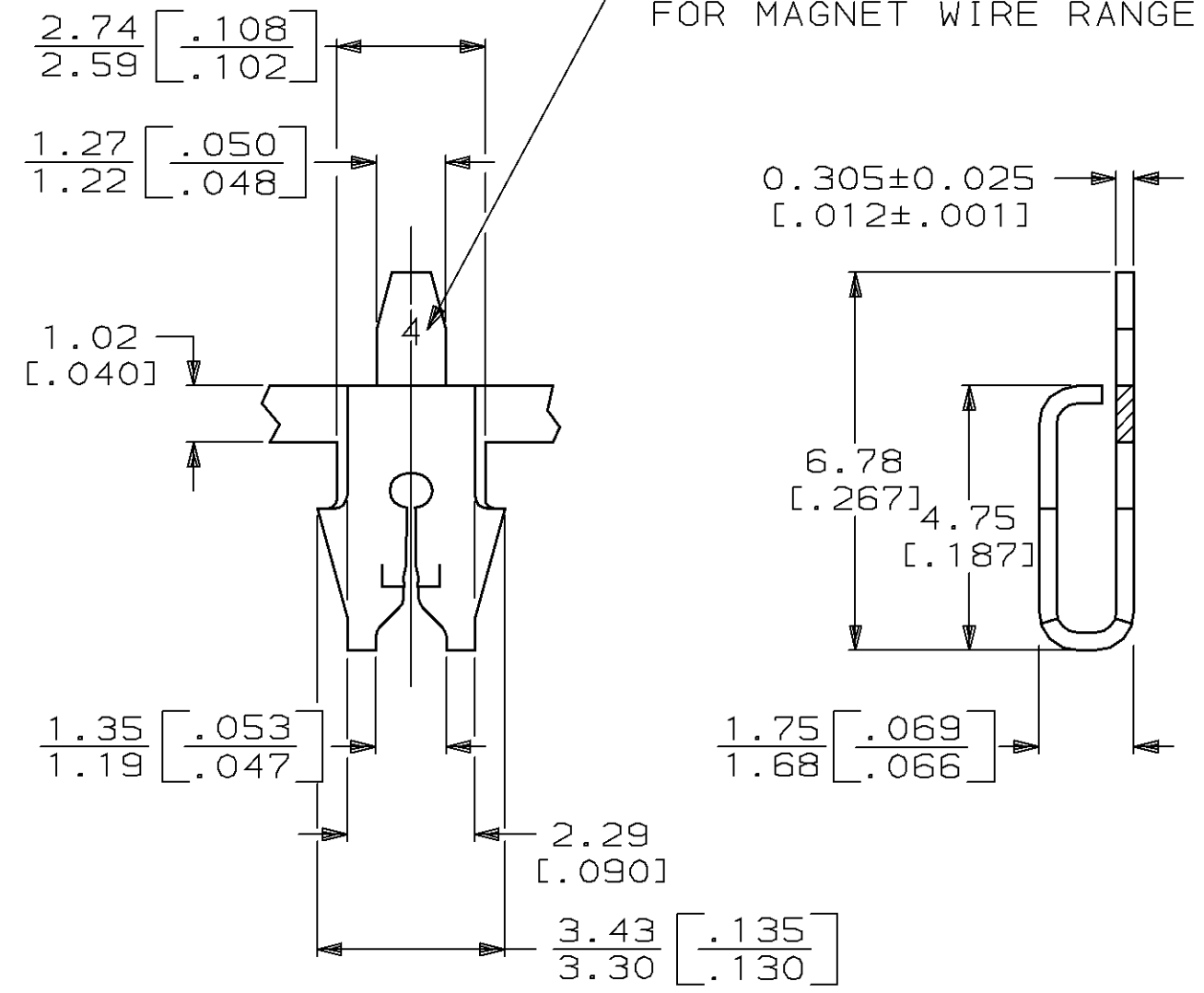

63565-1

PART NO

DO NOT SCALE PRINT. UNLESS SPECIFIED DIMENSIONS IN mm [INCHES] TOLERANCES ON: 2 PLC DEC ± 0.25 [.010] 3 PLC DEC ± - ANGLES ± - MATERIAL #4 HARD BRASS FINISH △3	DR 1/10/90 M.S. FEHER	<b>AMP</b> AMP INCORPORATED Harrisburg, Pa. 17105	
	CHK 1/11/90 J.R. RUTH		
	APPD 1/11/90 N.E. NEFF	NAME	TERMINAL, POSTED, MAG-MATE™
	APPD 1/12/90 T.L. SHUTTER	SIZE	<b>B</b>
PRODUCT SPEC -	APPLICATION SPEC 114-2069	CAGE CODE	00779
WEIGHT -		DRAWING NO	63565
		SCALE	8:1
		SHEET	1 OF 1

CUSTOMER DRAWING